



7000 Series

Door furniture & deadbolts



Sleek sophistication is at your fingertips with the Schlage 7000 Series. This contemporary lever range has a distinctively European feel. Blending form with function, the Schlage 7000 Series will allow you to express your individuality with lasting integrity. Beautifully designed down to the last detail, this series is manufactured from high quality stainless steel for heightened durability, good looks and great feel. The Schlage 7000 Series has a round rose with solid and tubular levers to choose from.

Features

- Constructed of quality components with solid or tubular stainless steel levers and die cast roses
- Built in privacy push-button for quick installation and ease of use
- The 7000 Series is suitable for use on fire door assemblies when used with fire rated mortice locks or latches
- Through bolts provide secure fixing, concealed by a round rose cover for aesthetic appeal
- Replaceable spring

Specification guide





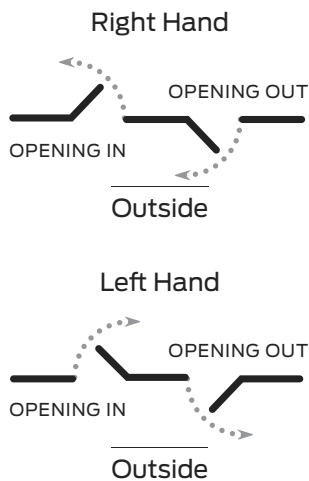

Function	Lever	Finish
Dummy trim7002	Albo solid713	Satin stainless steel..... SSS
Latch furniture7000	Alpha solid715	
Passage set7005	Angelo solid714	
Privacy set7006	Dali solid712	
	Degas solid705	
	Dulag solid708	
	Gavarni solid711	
	Kahlo solid707	
	Katz solid710	
	Raphael solid706	
	Vargas solid701	
	Vinci solid702	
	Alpha tubular29-Ø19mm	
	Jordaens tubular16-Ø19mm	
	Diablo tubular15-Ø19mm	
	Diablo mitred tubular60-Ø19mm	

- Function
Select the desired function e.g. Passage set 7005/
- Lever
Select the required lever design e.g. Dulag #708 7005/708
- Finish
Select the desired finish e.g. Satin stainless steel 7005/708SSS

Handing guide



Specifications	
Door type	Timber or metal
Door thickness	Latch furniture 35mm to 50mm Passage set 35mm to 50mm Privacy set 32mm to 42mm
Backset	60mm or 70mm
Spindle size	7.6mm
Compatible locks/latches	Tubular latches, ME Series mortice locks 990MF Series mortice locks
Fixing	Concealed through fixings
Materials	Solid or tubular stainless steel handles, die cast roses
Finish	Satin stainless steel
Warranty	7 year mechanical and finish when used on residential applications

Functions	Outside	Inside
7002 - Dummy trim Inactive lever which is used as a door pull or matching trim		
7000 - Latch furniture Two levers to be used with a latch, mortice lock or converted to dummy trim with fixing kit		
7005 - Passage set (60mm or 70mm backset) Both levers always unlocked		
7006 - Privacy set (60mm or 70mm backset) Push-button locks outside lever (outside emergency release). Inside lever unlocks door		

7000 Series solid stainless steel lever designs

Albo #713

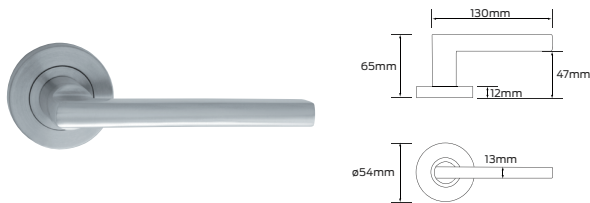

Alpha #715

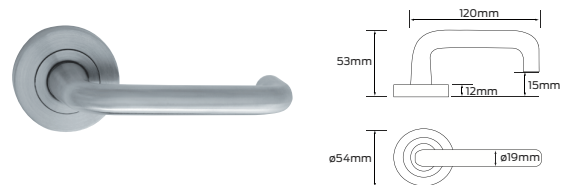

Angelo #714

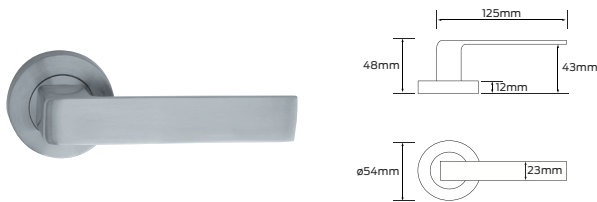

Dali #712

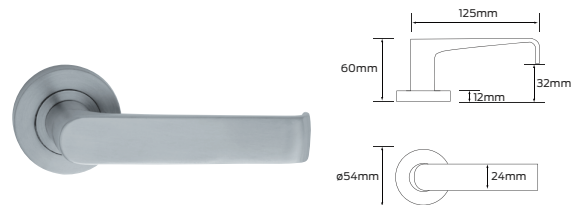

Degas #705 

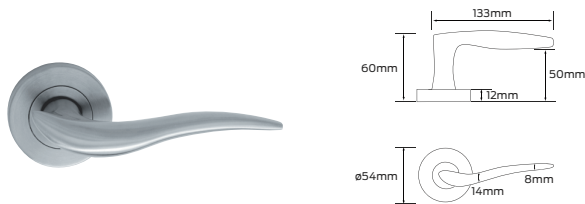

Dulag #708

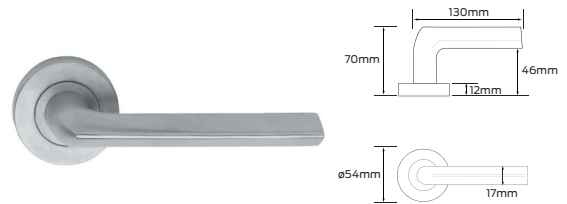

Gavarni #711



Kahlo #707 

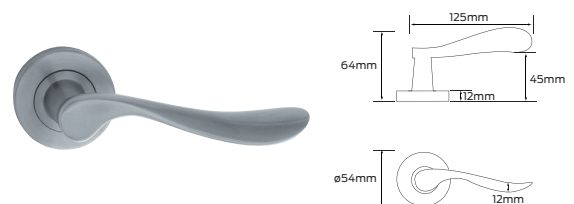

Katz #710

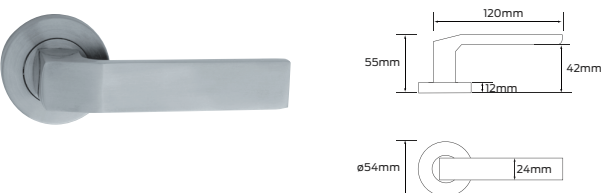

Raphael #706 

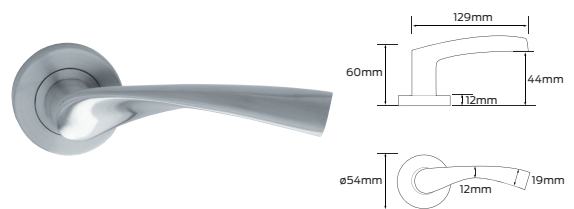

7000 Series solid stainless steel lever designs

Vargas #701

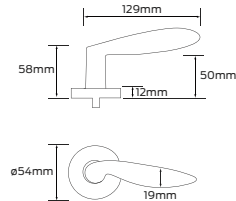
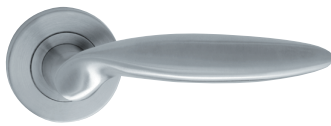

Vinci #702

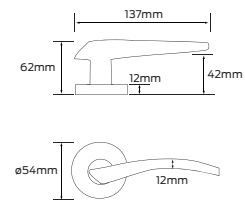

7000 Series tubular stainless steel lever designs

Alpha #29-Ø19mm

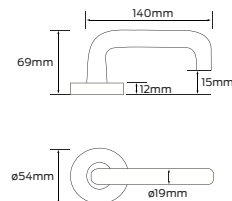
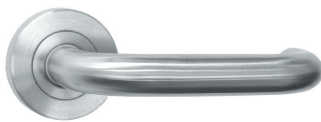

Jordaens #16-Ø19mm

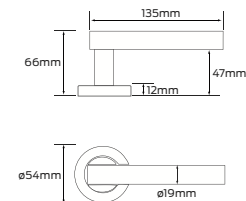
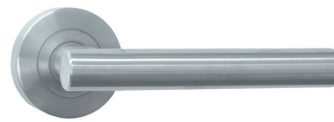

Diablo #15-Ø19mm

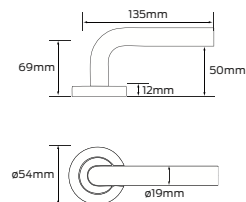

Diablo Mitred #60-Ø19mm

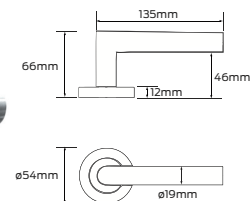

Passage door preparation

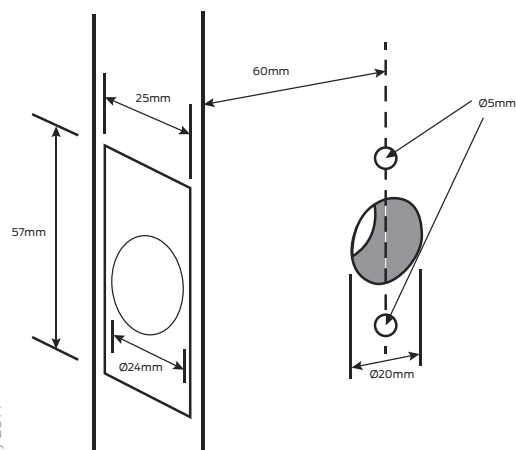

Privacy door preparation

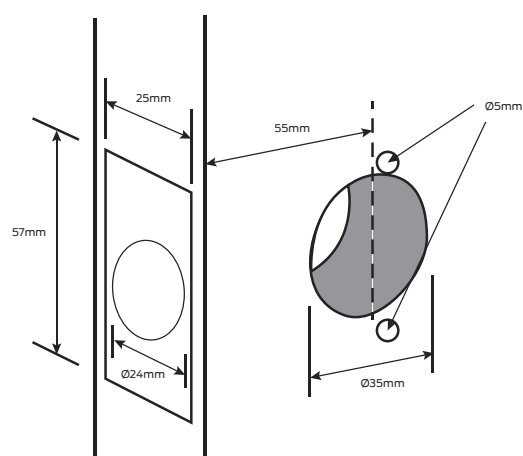

Denotes handing
Dummy trim only

7000 Series escutcheons

Turn #7007



Cylinder #7008

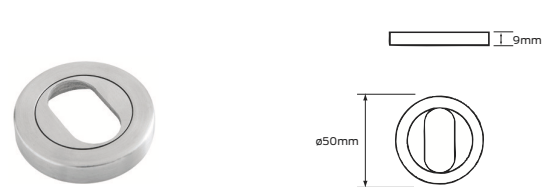

Emergency release #7009



Large turn #7010



Euro profile cylinder #7012

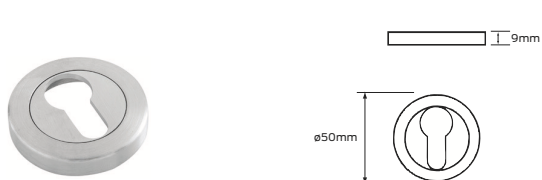

Indicating turn #7013



Indicating emergency release #7014



Indicating large turn #7015

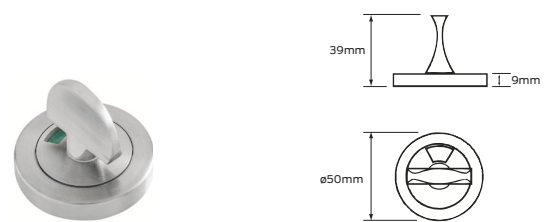

7000 Series accessories

Passage latch

60mm backset
Finishes: Chrome plate,
satin chrome plate

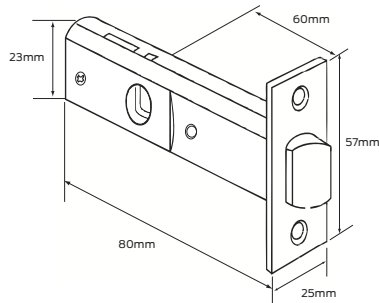

Privacy latch

60mm backset
Finishes: Chrome plate,
satin chrome plate

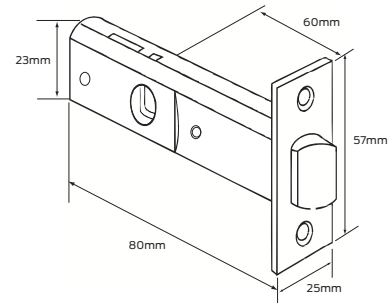

Passage latch

70mm backset
Finish: Satin stainless steel

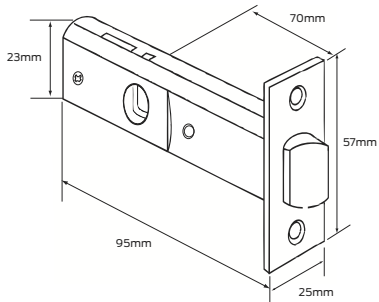

Privacy latch

70mm backset
Finish: Satin stainless steel

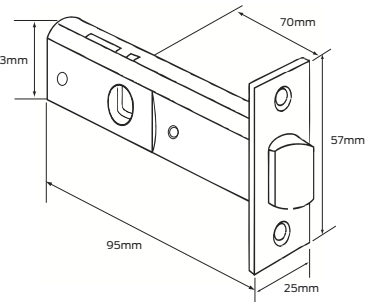

Dummy trim fixing kit

Allows conversion of lever
furniture to dummy trim function.
One kit required per lever

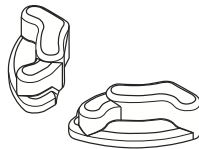

Rose caps

Available to mix and match finishes
with levers
Finish: Satin stainless steel

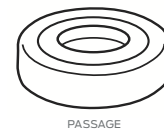

Universal rebate kit

Finish: Satin chrome plate

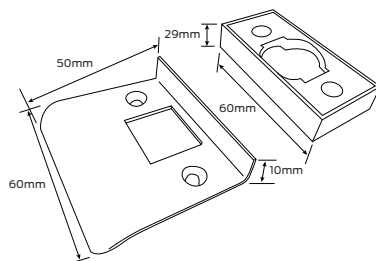

Emergency turn set

Turn escutcheon, emergency release
escutcheon and deadbolt
Finish: Satin stainless steel

